

RESOLUTION 2022-29

RESOLUTION APPROVING A 28E AGREEMENT WITH JOHNSON COUNTY REGARDING THE HERBERT HOOVER HIGHWAY AND CEDAR/JOHNSON ROAD IMPROVEMENTS.

WHEREAS, Johnson County is preparing to construct improvements to Herbert Hoover Highway N.E. to the west corporate boundary of the City of West Branch; and

WHEREAS, the City and Johnson County have agreed to enter into a 28E Agreement whereby Johnson County will construct part of its Herbert Hoover Highway project to the intersection of Cedar/Johnson Road; and

WHEREAS, the City and Johnson County have agreed to share costs for said project; and

WHEREAS, the parties have negotiated a 28E Agreement which outlines the obligations of each party as it pertains to the project.

NOW, THEREFORE, It Is Resolved by the Council of the City of West Branch, Iowa, that the aforementioned 28E Agreement be and the same is hereby approved. Further, the Mayor and City Clerk are hereby directed to execute the agreement on behalf of the City.

Passed and approved this 21st day of March, 2022.

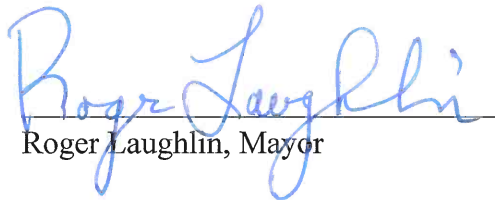
Roger Laughlin, Mayor

ATTEST:

Leslie Brick, City Clerk

**28E Project Agreement between Johnson County, Iowa and the City of West Branch, Iowa
Regarding the F44 (Herbert Hoover Highway NE) Phase 3 Roundabout Project,
LFM-HHH3-RAB--7X-52**

THIS PROJECT AGREEMENT (hereinafter “Agreement”) is made and entered into as of the Effective Date herein provided, by and between the City of West Branch (“City”) and Johnson County, State of Iowa (“County”) pursuant to Chapter 28E and Section 28E.12 of the Code of Iowa. The City and the County may hereinafter be referred to collectively as the “Parties”.

WHEREAS, both the City and the County are public agencies as is defined by Section 28E.2 of the Code of Iowa (2022); and

WHEREAS, the City and the County recognize that the route known as F44 (West Main Street within the City and Herbert Hoover Highway NE within the County) is an important link between the City and the County and is a roadway with common interest and responsibility; and

WHEREAS, the City and the County are in the process of designing improvement Project #LFM-HHH3-RAB--7X-52 on F44 beginning approximately 1,000’ west of Wapsi Avenue in Johnson County, Iowa at project Station 102+00 and ending approximately 400’ east of the Cedar County-Johnson County line in Cedar County, Iowa at project Station 116+00, along with improvements to the intersection of F44 and Johnson Cedar Road on the Cedar County-Johnson County line; and

WHEREAS, the City and the County wish to enter into an agreement relating to improving their respective portions of F44 and Johnson Cedar Road and sharing the cost thereof.

IT IS NOW AGREED that, in consideration of the mutual promises and agreements herein contained and upon the following terms and conditions, the City and the County enter into an agreement providing for cooperative action regarding the proposed construction project described above and that said cooperative actions include the following:

- 1. Purpose and Project Scope:** The purpose of this Agreement is, among other things, to define specific responsibilities for and implement construction of improvements to F44 and Johnson Cedar Road in Johnson County, Iowa and Cedar County, Iowa. Those portions of F44 and Johnson Cedar Road under the County’s jurisdiction are designated as Division I. Those portions of F44 and Johnson Cedar Road under the City’s jurisdiction or responsibility are designated as Division II. Said divisions are graphically depicted in the attached Herbert Hoover Highway Roundabout Concept Plans (3 pages) and tabulated in

Table 1 below. Said Divisions are further classified into project Segments One through Four as indicated in Table 1. Said improvements shall consist generally of grading and paving (altogether as described in this paragraph, the “Project”). The City improvements (Division II) may include an urban cross section design with curb and gutters along with storm sewers and intakes as needed. County improvements (Division I) are intended to include a rural cross section which exclude a curb and gutter along the outside edge of the paved roadway. The costs associated with upgrading Division I improvements from a rural to an urban cross section will be included with Division II.

Table 1: Construction Limits for Project # LFM-HHH3-RAB--7X-52						
Segment	Station From	Station To	Length (feet)	Side of Road	Construction Share (%)	Division
1	102+00	112+00	1,000	Both	100*	I (Johnson County)
2	112+00	116+00	400	Both	100	II (City of West Branch)
3	Johnson Cedar Rd. north of F44 to match existing			Both	100	II (City of West Branch)
4	Johnson Cedar Rd. south of F44 as needed to match existing			West	100*	I (Johnson County)
				East	100	II (City of West Branch)

*Costs to upgrade the cross section from a rural to urban cross section, including desired sidewalks and associated pedestrian accommodations, will be added to Division II and shall be the sole responsibility of the City.

2. **Consideration:** The mutual consideration herein is the cooperative undertaking of the improvements to F44. No separate legal entity is created by this Agreement. The Johnson County Board of Supervisors shall administer the County’s duties and responsibilities herein. The City Council of West Branch shall administer the City’s duties and responsibilities herein.

3. **Responsibility for work:** The County shall be responsible for coordinating the project development as necessary for the proposed improvements. This responsibility generally shall include, but not necessarily be limited to preconstruction project development and design: preparation of plans, specifications, letting documents, and review of shop drawings. The City’s Engineer shall review and approve the plans prior to letting the project. All necessary design work shall be prepared by the County (which may be by design professional(s) or consultants engaged by the County (the “County’s Engineer”), the cost of which shall be included in the costs of the Project), but may incorporate plans, designs, and/or supporting information developed by the City. The County and/or County’s Engineer will carry out the letting and award of the construction contract, construction layout, and owners’ project management for the Project. The County’s Engineer shall also provide contract and construction administration and construction inspection services for the Project; and shall prepare construction progress estimates bi-weekly. The County will issue progress vouchers to the contractor.

Final acceptance of work performed within their respective jurisdictions shall be the responsibility of the corresponding jurisdiction; however, since the City shall be reimbursing the County for construction costs paid as progress on the Project is achieved, the City (i) shall promptly review Project progress as milestone payment applications are prepared (i.e. approve or deny progress payment applications within 7 calendar days of the County's request for review), (ii) not unreasonably withhold approval of progress payment applications or final acceptance of the work, and (iii) not withhold final acceptance for any work contained in a previously-approved progress payment application. The City will designate a licensed engineer who will be available to visit the project site as needed to address construction issues as they arise.

Each entity shall be responsible for obtaining any necessary right-of-way interests, temporary construction easements, utility relocations, and permits required in their respective county/jurisdiction so as not to delay project construction. Each party shall ensure that all contracts with consultants, constructors, or other service providers for this Project where insurance is maintained to protect the City or County as the case may be, shall also name the other party to this agreement as an additional insured and that such other party shall be included as an additional indemnified party in the same manner and extent as the contracting vendee may so be.

4. **Timing of work:** The City and the County shall use all good faith efforts to have mainline paving complete and the intersection open to traffic before winter 2022 shutdown and substantially complete construction on the entire Project on or before May 31, 2023. Project closeout is expected to be completed no later than July 31, 2023.
5. **Financing:** The City and the County agree to share in the costs of this Project as set out below. Estimated costs are for budgeting purposes only.
 - a) The City and the County shall each separately bear and have sole and exclusive responsibility for the actual costs for obtaining any necessary rights-of-way, easements, permits, or utility relocations incurred for such Project-related acquisitions or activity within their respective jurisdictions or areas of responsibility under Table 1.
 - b) For engineering design fees, the City shall pay \$6,598 of the engineering design fees for survey work and design that is exclusive to the City and the County shall pay \$34,907 of the engineering design for Right of Way Acquisitions exclusive to the County. For the remaining engineering design fees related to the Project, the City and the County shall apportion engineering design fees based upon each Division's pro-rata share of the final design estimate of project construction costs. Total engineering design fees are estimated at \$124,076. A detailed resource allocation estimates for design fees and their apportionment between the City and County prepared by Anderson-Bogert Engineers and Surveyors, Inc. and dated November 23, 2020 and December 9, 2021 (Amendment No. 1) is on file with the County Engineer and incorporated by this reference.
 - c) The City and the County shall apportion construction administration, management, project inspection, and construction survey costs based upon each Division's pro-rata

share of actual project construction costs. Said costs are estimated to total \$110,000 or 8% of the construction costs.

- d) The City and the County shall apportion actual construction costs fully to the corresponding jurisdiction based on the divisions described in Table 1, above. Construction costs are estimated to total \$1,380,000 with Division I and Division II work amounting to \$774,000 and \$606,000 respectively.

- 6. Construction Costs Exceeding Estimate:** The cost estimate for the portion of construction for which the City is responsible herein is \$636,000, including an approximate five percent (5%) contingency. The cost estimate for the portion of construction for which the County is responsible herein is \$813,000, including an approximate five percent (5%) contingency. If the lowest responsive, responsible bid received by the County results in the City portion exceeding \$636,000, the City may reject all bids and if the same bid results in the County portion exceeding \$813,000, the County may reject all bids. If either entity rejects all bids, the bids shall be rejected and the Parties shall have no further obligations under this Agreement, unless the Parties have reached an agreement related to financing Project Costs exceeding the cost estimate or amending the scope of the Project.

7. Timing of payments:

For engineering, design, construction, and construction management services provided by the County's Engineer, the contractor, and/or other firms for the benefit of the Project, the City shall reimburse the County consistent with its responsibilities set out above as invoices for services are tendered to the County by such vendors, consultants, and/or service providers. All reimbursements shall be paid within a reasonable amount of time after presentment, but in no event more than forty-five (45) days after the County has presented an invoice to the City for reimbursement, unless there is a good faith, material dispute as to the basis or validity of the underlying charges described in a contested invoice or progress estimate, in which case such dispute must be communicated in writing to the County no more than ten (10) days after the County has delivered such invoice to the City.

- 8. Effective date:** This Agreement shall be effective when approved and signed by the Johnson County Board of Supervisors and the City Council of West Branch, and filed with the Secretary of State as provided in Chapter 28E.8 of the Code of Iowa (2022).

- 9. Duration:** This Agreement shall continue in force until final acceptance of work is made by the Johnson County Engineer and the City Engineer and final payment has been made to the County by the City as set forth above.

- 10. Interpretation and enforcement:** Interpretation and enforcement of the Agreement shall be in accordance with Iowa law, Chapter 28E of the Code of Iowa (2022), and statutes respecting the rights and responsibilities of the political subdivisions.

- 11. Dispute resolution:** The parties acknowledge their mutual desire to complete the proposed improvements for this Project as listed above. The parties therefore agree to work diligently and negotiate in good faith to reach any agreements necessary to secure completion of the proposed improvements. Matters in dispute or subject to interpretation shall be first

submitted to the parties for resolution prior to either party pursuing administrative or judicial remedies. In the event such matters must be submitted to the parties, they shall be submitted specifically to the Mayor of the City of West Branch, as representative for the City, and to the Johnson County Engineer, as representative for the County, who will both make a good faith effort to resolve the dispute.

- 12. Amendment:** This Agreement contains the entire Agreement between the Parties hereto and may be amended only in writing which is executed by the County and the City.
- 13. Severability:** If any provision or provisions of this Agreement shall be held to be invalid, illegal, or unenforceable, the validity, legality, and enforceability of the remaining provisions shall not in any way be affected or impaired thereby.
- 14. Notices:** Any notice under this Agreement shall be in writing. Notices to the City shall be addressed to: City Clerk, City of West Branch, 110 N Poplar St., P.O. Box 218, West Branch, Iowa 52358. Notices to the County shall be addressed to: Chairperson, Johnson County Board of Supervisors, Johnson County, 913 S. Dubuque Street, Suite 101, Iowa City, Iowa 52240.

[signatures on following page]

JOHNSON COUNTY

This Agreement was approved by official action of the Johnson County Board of Supervisors in official session on the _____ day of _____, 2022.

Royceann Porter, Chairperson
Johnson County Board of Supervisors

ATTEST: _____
Travis Weipert, County Auditor

CITY OF WEST BRANCH
By: Roger Laughlin
Roger Laughlin, Mayor

ATTEST: Adam Kofoed
Adam Kofoed, City Administrator

STATE OF IOWA, CEDAR COUNTY: ss

On this 23 day of March, 2022, before me, the undersigned, a Notary Public in and for the State of Iowa, personally appeared Roger Laughlin and Adam Kofoed, to me personally known, who, being by me duly sworn, did say that they are the Mayor and City Administrator, respectively, of the City of West Branch, Iowa, a municipal corporation; that the seal affixed to the foregoing instrument is the corporate seal of the municipal corporation; and that the instrument was signed and sealed on behalf of the municipal corporation by the authority of its City Council, as contained in Resolution No. 2022-29 of the City Council on the 21st day of March, 2022 and that Roger Laughlin and Adam Kofoed acknowledged the execution of the instrument to be their voluntary act and deed and the voluntary act and deed of the corporation, by it and by them voluntarily executed.

Leslie Brick
Notary Public in and for the State of Iowa

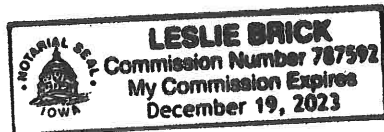

Exhibit B
Herbert Hoover Highway/Johnson Cedar Road Roundabout Amendment No. 1 Design Fees

Cost Estimate \$ 1,380,000

Resource Allocation Estimate
 Anderson-Bogert Engineers and Surveyors, Inc.
 December 9, 2021

Estimated Construction Cost Share	
Div I (Jo Co)	Div II (WB)
\$774,000	\$606,000
56%	44%

TASK	TASK TOTALS	SUB EXPENSE	ENGINEER VI	ENGINEER IV	ENGINEER II	SURVEYOR IV	SURVEYOR II	SURVEY FIELD WORK	Div I (Jo Co)	Div II (WB)
	Cost/hour		\$188.00	\$148.00	\$108.00	\$161.00	\$107.00	\$167.00		
1	Project Management									
	Coordination between Johnson County, City of West Branch/V&K	\$2,960.00	10	10	10				\$1,657.60	\$1,302.40
	Subtotal (HOURS)	20	10	0	10	0	0	0		
	Subtotal (DOLLARS)	\$2,960.00	\$1,880.00	\$0.00	\$1,080.00	\$0.00	\$0.00	\$0.00		
3	Right of Way Acquisitions									
	Plats and Exhibits	\$14,332.00	4	8	8	24	64	12	\$14,332.00	\$0.00
	Assistance with Acquisitions	\$4,327.00	8	8	8		1	4	\$4,327.00	\$0.00
	Appraisals and Acquisitions (Johnson County)	\$14,040.00							\$14,040.00	\$0.00
	Subtotal (HOURS)	141	12	8	16	24	65	16		
	Subtotal (DOLLARS)	\$32,699.00	\$14,040.00	\$2,256.00	\$1,184.00	\$1,728.00	\$3,864.00	\$6,955.00		
4	Permits									
	Water main permit (West Branch)	\$836.00	1	6					\$0.00	\$836.00
	Subtotal (HOURS)	7	1	0	6	0	0	0		
	Subtotal (DOLLARS)	\$836.00	\$188.00	\$0.00	\$648.00	\$0.00	\$0.00	\$0.00		
5	Concepting									
	Concepting	\$4,208.00	4		32				\$2,356.48	\$1,851.52
	Cost Estimates	\$1,024.00	2		6				\$0.00	\$1,024.00
	Subtotal (HOURS)	44	6	0	38	0	0	0		
	Subtotal (DOLLARS)	\$5,232.00	\$1,128.00	\$0.00	\$4,104.00	\$0.00	\$0.00	\$0.00		
	Preliminary Plans									
	Storm Sewer and Drainage Analysis (West Branch)	\$4,924.00	1	32					\$2,757.44	\$2,166.56
	Water Main Plan and Profile (West Branch)	\$2,556.00	1	16					\$1,431.36	\$1,124.64
	Subtotal (HOURS)	50	2	48	0	0	0	0		
	Subtotal (DOLLARS)	\$7,480.00	\$376.00	\$7,104.00	\$0.00	\$0.00	\$0.00	\$0.00		
	Check Plans									
	Storm Sewer and Water Main Tabulations/Estimate Reference (West B	\$1,076.00	1	6					\$0.00	\$1,076.00
	Tabulating Divisions and Costs	\$1,696.00	2	6	4				\$949.76	\$746.24
	Storm Sewer and Drainage Analysis (Update) (West Branch)	\$336.00	1	1					\$0.00	\$336.00
	Water Main Plan and Profile (Update) (West Branch)	\$484.00	1	2					\$0.00	\$484.00
	Subtotal (HOURS)	24	5	15	4	0	0	0		
	Subtotal (DOLLARS)	\$3,592.00	\$940.00	\$2,220.00	\$432.00	\$0.00	\$0.00	\$0.00		
	PROJECT TOTAL (HOURS)	286	36	71	74	24	65	16		
	PROJECT TOTAL (DOLLARS)	\$52,799.00	\$14,040.00	\$6,768.00	\$10,508.00	\$7,992.00	\$3,864.00	\$6,955.00	\$ 41,851.64	\$ 10,947.36
	TOTAL ESTIMATED NOT TO EXCEED FEE	\$52,799.00								

Div I only items \$32,699.00 Div II only items \$3,756.00

SUMMARY		Division I (Jo Co)	Division II (WB)	Div I only	Div II only
Original Design Contract	\$ 71,277.00	\$ 39,295.12	\$ 31,981.88	\$ 2,208.00	\$ 2,842.00
Amendment #1	\$ 52,799.00	\$ 41,851.64	\$ 10,947.36	\$ 32,699.00	\$ 3,756.00
Amended Design Contract Total	\$ 124,076.00	\$ 81,146.76	\$ 42,929.24	\$ 34,907.00	\$ 6,598.00

**2021 F44/HERBERT HOOVER HIGHWAY NE AND JOHNSON CEDAR ROAD NE
INTERSECTION EXHIBIT - ROUNDABOUT
OPINION OF PROBABLE CONSTRUCTION COSTS - 2-18-2022**

ITEM NO.	ITEM CODE	ITEM	UNIT	COST				TOTAL	WEST BRANCH	JOHNSON CO.	UNIT PRICE	JOHNSON CO.	WEST BRANCH	TOTAL
				JOHNSON CO.	WEST BRANCH	TOTAL	UNIT PRICE							
1	2101-0850001	CLEAR+GRUB	EACH	5	3	8				\$ 1,000.00	\$ 5,000.00	\$ 3,000.00	\$ 8,000.00	
2	2102-0710070	EXCAVATION, CLASS 10, ROADWAY AND BORROW	CY	15469.3	5132.2	20601.5				\$ 10.00	\$ 154,693.00	\$ 51,322.22	\$ 206,015.22	
3	2105-8425015	TOPSOIL, STRIP, SALVAGE AND SPREAD	CY	1400.9	506.7	1907.6				\$ 5.00	\$ 7,004.50	\$ 2,533.50	\$ 9,538.00	
4	2113-0001100	SUBGRADE STABIL MAT'L, POLYMER GRID	SY	957.7	784.2	1741.9				\$ 6.00	\$ 5,745.20	\$ 4,705.20	\$ 10,450.40	
5	2115-0100000	MODIFIED SUBBASE, 6"	CY	798.1	653.5	1451.6				\$ 35.00	\$ 27,933.50	\$ 22,872.50	\$ 50,806.00	
6	2210-0475990	MACADAM STONE FOR SOFT SPOTS	CY	159.6	130.7	290.3				\$ 40.00	\$ 6,384.00	\$ 5,228.00	\$ 11,612.00	
7	2213-7100400	RELOCATION OF MAILBOX	EACH	1.0	0.0	1.0				\$ 200.00	\$ 200.00	\$ -	\$ 200.00	
8	2301-1033090	PCC PAVEMENT, CLASS A, CLASS 3, 9"	SY	4019.8	3310.8	7330.6				\$ 50.00	\$ 200,990.00	\$ 165,540.00	\$ 366,530.00	
9	2301-1033090	PCC PAVEMENT, CLASS A, CLASS 3, 9", COLORED	SY	232.1	230.2	462.3				\$ 125.00	\$ 29,013.33	\$ 28,771.53	\$ 57,784.86	
10	2301-1487506	MEDIAN, PCC, 6"	SY	110.8	421.2	532.0				\$ 80.00	\$ 8,864.00	\$ 33,696.00	\$ 42,560.00	
11	2301-6911722	PCC PAVEMENT SAMPLES	LS	0.55	0.45	1.0				\$ 4,000.00	\$ 2,200.00	\$ 1,800.00	\$ 4,000.00	
12	2303-0003000	HOT MIX ASPHALT MIXTURE, COMMERCIAL MIX	TON	63.4	63.4	126.8				\$ 150.00	\$ 9,510.00	\$ 9,510.00	\$ 19,020.00	
13	2312-8260201	GRAVEL SHOULDER, 4"	TON	185.7	8.4	194.1				\$ 30.00	\$ 5,571.00	\$ 252.00	\$ 5,823.00	
14	2315-8275023	SURFACING, DRIVEWAY, CLASS A CRUSHED STONE	TON	123.2	0.0	123.2				\$ 30.00	\$ 3,696.00	\$ -	\$ 3,696.00	
15	2123-7450020	SHOULDER FINISHING, EARTH	STA	19.9	9.8	29.7				\$ 175.00	\$ 3,482.50	\$ 1,715.00	\$ 5,197.50	
16	2402-0425031	GRANULAR BACKFILL	TON	77.0	77.0	154.0				\$ 35.00	\$ 2,695.00	\$ 2,695.00	\$ 5,390.00	
17	2402-2720100	EXCAVATION, CL 20, ROWY PIPE CULV	CY	83.3	84.4	167.7				\$ 10.00	\$ 833.00	\$ 844.00	\$ 1,677.00	
18	2417-0225018	APRONS, METAL, 18 IN. DIA.	EACH	2.0	0.0	2.0				\$ 295.00	\$ 590.00	\$ -	\$ 590.00	
19	2417-0225024	APRONS, RCP, 24 IN. DIA.	EACH	1.0	1.0	2.0				\$ 2,100.00	\$ 2,100.00	\$ 2,100.00	\$ 4,200.00	
20	2417-1060024	CULVERT, CORRUGATED METAL ENTRANCE PIPE, 18 IN. DIA.	LF	30.0	0.0	30.0				\$ 50.00	\$ 1,500.00	\$ -	\$ 1,500.00	
21	2417-1060024	CULVERT, REINFORCED CONCRETE PIPE, 24 IN. DIA.	LF	95.0	95.0	190.0				\$ 85.00	\$ 8,075.00	\$ 8,075.00	\$ 16,150.00	
22	2435-0250700	INTAKE, SW-507	EACH	0.0	2.0	2.0				\$ 5,500.00	\$ -	\$ 11,000.00	\$ 11,000.00	
23	2502-8212034	SUBDRAIN, LONGITUDINAL (SHOULDER) 4 IN. DIA.	LF	1892.1	1162.4	3054.5				\$ 4.50	\$ 8,514.45	\$ 5,230.62	\$ 13,745.07	
24	2502-8212036	SUBDRAIN OUTLET, DR-306	EACH	3.0	3.0	6.0				\$ 350.00	\$ 1,050.00	\$ 1,050.00	\$ 2,100.00	
25	2507-9250005	ENGINEERING FABRIC	SY	45.0	45.0	90.0				\$ 20.00	\$ 900.00	\$ 900.00	\$ 1,800.00	
26	2507-6800061	REVEIMENT, CLASS E	TON	50.0	50.0	100.0				\$ 70.00	\$ 3,500.00	\$ 3,500.00	\$ 7,000.00	
27	2510-6749590	PAVEMENT REMOVAL	SY	3173.6	1955.4	5129.0				\$ 8.00	\$ 25,388.80	\$ 15,645.20	\$ 41,034.00	
28	2519-4200090	REMOVAL AND REINSTALL FENCE, 6' HEIGHT	LF	260	0	260				\$ 50.00	\$ 13,000.00	\$ -	\$ 13,000.00	
29	2524-9325150	SIGNS	LS	0.50	0.50	1.0				\$ 20,000.00	\$ 10,000.00	\$ 10,000.00	\$ 20,000.00	
30	2526-8285000	CONSTRUCTION SURVEY	LS	0.55	0.45	1.0				\$ 15,000.00	\$ 8,250.00	\$ 6,750.00	\$ 15,000.00	
31	2527-9263109	PAINTED PAVEMENT MARKINGS, WATERBORNE	STA	45.6	25.2	70.8				\$ 50.00	\$ 2,280.00	\$ 1,260.00	\$ 3,540.00	
32	2527-9263137	PAINTED SYMBOL+LEGEND, WATERBORNE	EACH	4.00	4.00	8.0				\$ 500.00	\$ 2,000.00	\$ 2,000.00	\$ 4,000.00	
33	2538-4880005	MOBILIZATION	LS	0.55	0.45	1.0				\$ 90,000.00	\$ 49,500.00	\$ 40,500.00	\$ 90,000.00	
34	2554-0114012	WATER MAIN, TRENCHED, 12" PVC	LF	0.0	319.8	319.8				\$ 85.00	\$ -	\$ 27,183.00	\$ 27,183.00	
35	2554-0202000	FITTINGS BY WEIGHT	LBS	0.0	456.0	456.0				\$ 15.00	\$ -	\$ 6,840.00	\$ 6,840.00	
36	2528-8445110	TRAFFIC CONTROL	LS	0.6	0.5	1.0				\$ 30,000.00	\$ 16,500.00	\$ 13,500.00	\$ 30,000.00	
37	2599-9999005	REMOVE AND REINSTALL FIRE HYDRANT	EACH	0.0	1.0	1.0				\$ 2,500.00	\$ -	\$ 2,500.00	\$ 2,500.00	
38	2599-9999009	REMOVE OF CULVERT	LF	28.0	28.0	56.0				\$ 25.00	\$ 700.00	\$ 700.00	\$ 1,400.00	
39	2599-9999008	REMOVE OF WATER MAIN	LF	0.0	249.0	249.0				\$ 20.00	\$ -	\$ 4,980.00	\$ 4,980.00	
40	2601-2634105	MULCHING, BONDED FIBER MATRIX	ACRE	1.7	0.9	2.6				\$ 2,625.00	\$ 4,462.50	\$ 2,362.50	\$ 6,825.00	
41	2602-2696070	HYDRAULIC SEEDING, PERMANENT RURAL	ACRE	1.7	0.9	2.6				\$ 600.00	\$ 1,020.00	\$ 540.00	\$ 1,560.00	
42	2602-0000020	SILT FENCE	LF	1780	760	2540				\$ 2.00	\$ 3,560.00	\$ 1,520.00	\$ 5,080.00	
43	2602-0000071	REMOVAL OF SILT FENCE OR SILT FENCE FOR DITCH CHECKS	LF	1780	760	2540				\$ 0.50	\$ 890.00	\$ 380.00	\$ 1,270.00	
44	2602-0000312	PERIMETER AND SLOPE SEDIMENT CONTROL DEVICE, 12 IN. DIA.	LF	440	440	880				\$ 2.00	\$ 880.00	\$ 880.00	\$ 1,760.00	
45	2602-0000350	REMOVAL OF PERIMETER AND SLOPE SEDIMENT CONTROL DEVICE	LF	440	440	880				\$ 0.50	\$ 220.00	\$ 220.00	\$ 440.00	
46	2602-0010010	MOBILIZATION, EROSION CONTROL	EACH	1	1	2				\$ 650.00	\$ 650.00	\$ 650.00	\$ 1,300.00	
47	2602-0010020	MOBILIZATION, EMERGENCY EROSION CONTROL	EACH	1	1	2				\$ 950.00	\$ 950.00	\$ 950.00	\$ 1,900.00	
48	9999-0000001	PERMANENT ACQUISITION	SF	62303.3	20477.2	82780.5				\$ 0.23	\$ 14,233.76	\$ 4,705.76	\$ 19,039.52	
49	9999-0000003	LIGHTING	LS	0.5	0.5	1.0				\$ 33,000.00	\$ 16,500.00	\$ 16,500.00	\$ 33,000.00	
											SUBTOTAL	\$ 671,826.54	\$ 526,909.03	\$ 1,198,735.57
											15% CONTINGENCY	\$ 100,773.98	\$ 79,036.35	\$ 179,810.34
											TOTAL	\$ 772,600.52	\$ 605,945.38	\$ 1,378,545.91

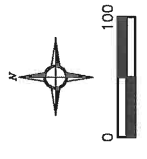
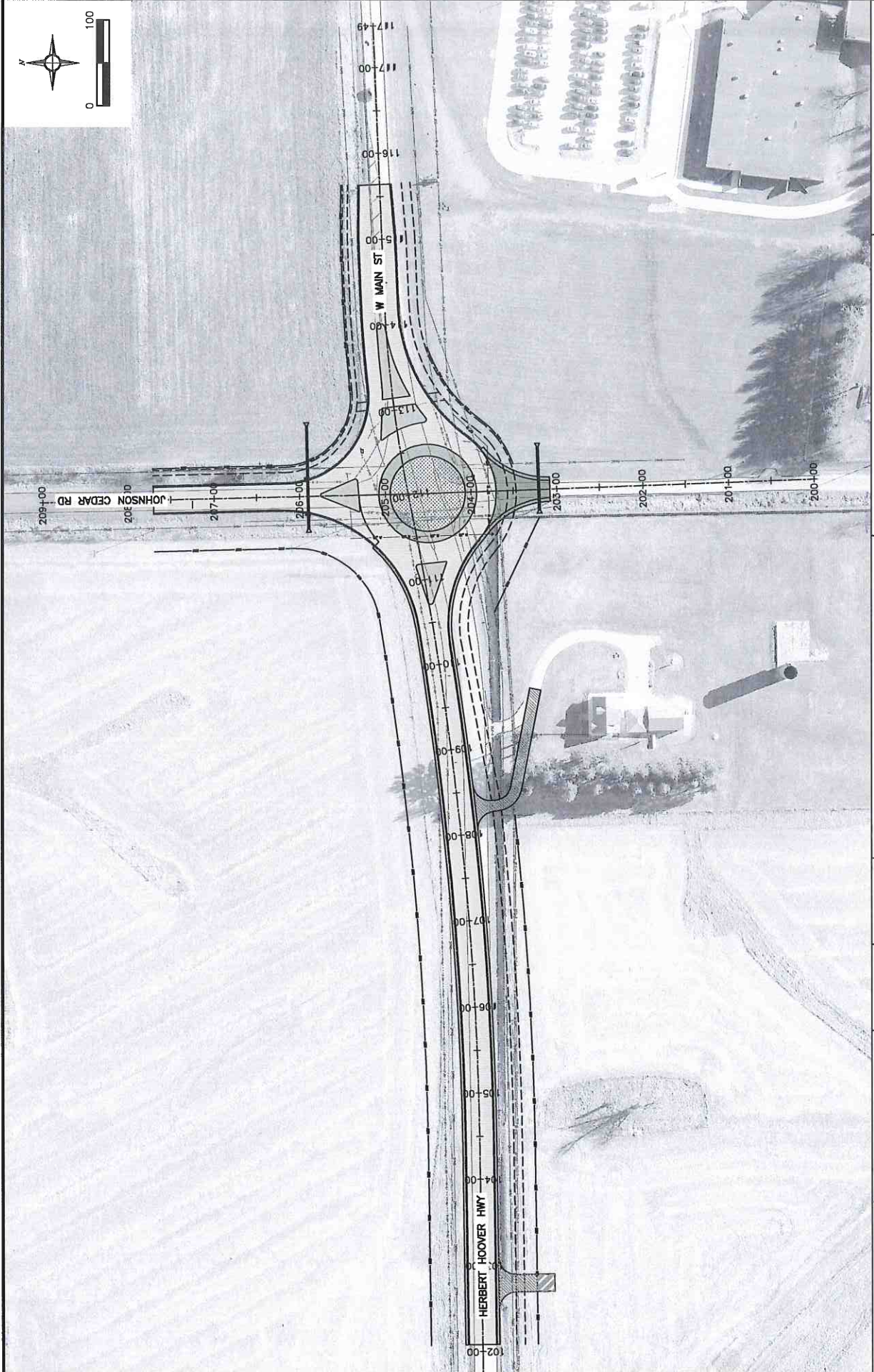

L:\R3701\ACAD\221008\DWG\1008_Prop.dwg 2-18-22 11:49:15 AM

ANDERSON BOGERT

ENGLISH

IOWA DOT

JOHNSON COUNTY

PROJECT NUMBER

STBC-SWAP-C052(120)-FG-52

SHEET NUMBER

HERBERT HOOVER HWY - JOHNSON COUNTY - STBC-SWAP-C052(120)-FG-52

